

# Sanicom 2

## Grey water

Sanicom 2 is a two-pump lifting station designed for commercial use. It removes grey water up to 90 °C (max 5 mins) from restaurant kitchens, laundries, doctors' surgeries, pubs, hair salons etc. Sanicom 2 consists of 2 independent pumps. The second pump assists the first in case of a sudden large water supply. The tank is equipped with 2 immersion tubes controlling the motor on the one hand and the alarm system on the other. A remote wired alarm is available as an option.



### PERFORMANCES

- Total dynamic head : 15 m
- Max. flow rate : 16 m<sup>3</sup>/h

### PRODUCT BENEFITS

- Ability to pump grey water up to 90 °C.
- Easy installation without soil disbursement.
- 2 low side inlets Ø ext. 80 (connections possible in Ø ext. 50 or Ø ext. 40).
- Supplied with remote control unit: 2 alternating pumps for more intensive use.
- Removable motors and level sensors for ease of maintenance.



BV Cert. 6045364



### DELIVERED AS STANDARD

Classic control Box



### OPTIONAL

Wired alarm box Sanicom 2



### CONNECTIONS



- External inlet diameter : 40, 50, 80 mm
- Discharge diameter ext. : 50 mm
- Ext. ventilation diameter : 50 mm



Multi-channel

## DIMENSIONS

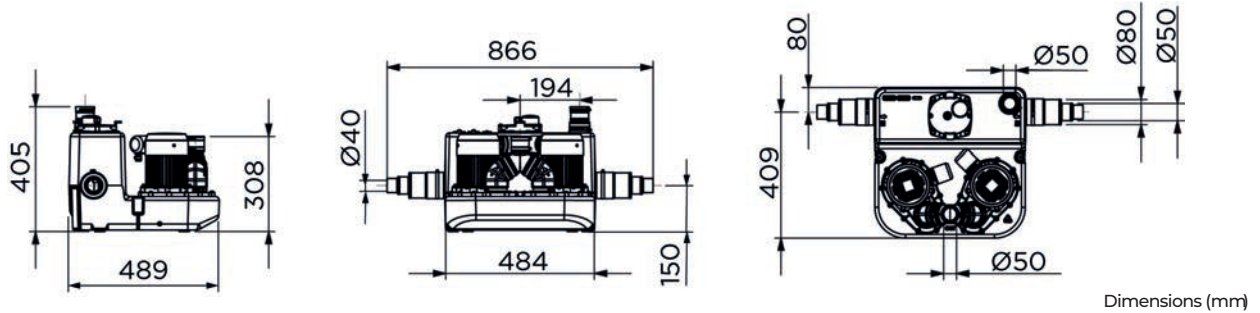

## CURVE

Discharge height (m)

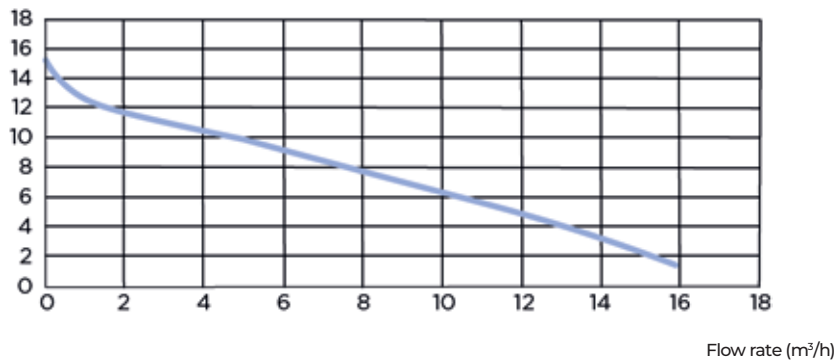

### Sanicom 2 v02

Type of control box	Classic control Box
Material	
Tank	PE
Pump housing	PA 12 GF
Motor housing	Aluminium
Impeller	PA 6 GF
Technical features	
Voltage (V)	230
Frequency (Hz)	50-60
Power consumption P1 (W)	1500
Power output P2 (W)	1050
IP Rating	IPX4
Hydraulics	
Total dynamic head (m)	15
Max. flow rate (m <sup>3</sup> /h)	16
External inlet diameter (mm)	40, 50, 80
Discharge diameter ext. (mm)	50
Ext. ventilation diameter (mm)	50
Total volume (L)	34
Useable volume (L)	13
ON Level /OFF level (mm)	145/60
Alarm level (mm)	215
Particle size (mm)	8
Max. temperature of the pumped liquid (5 min)	90 °C
Type of impeller	Multi-channel
Type of activation	Pneumatic
Identification and logistics	
Gross weight (kg)	25
Factory code	COM2002