

Position	Name	Quantity
A	Greasly 2A body	1
B	Lid with locking ring and gasket	2
C	Inspection window	1
Y	Automatic wather filling unit	1
F	Mixer	1
G	Alarm	1
J	Disposal pump unit	1
H	Control panel	1
K	Remote control (optional)	1
Greasly 4A Pump technical characteristics		
	Flow rate	2 l/s
	Total volume	650 L
	Grease volume	80 L
	Separator volume	450 L
	Sludge trap volume	200 L
	Weight	198 kg

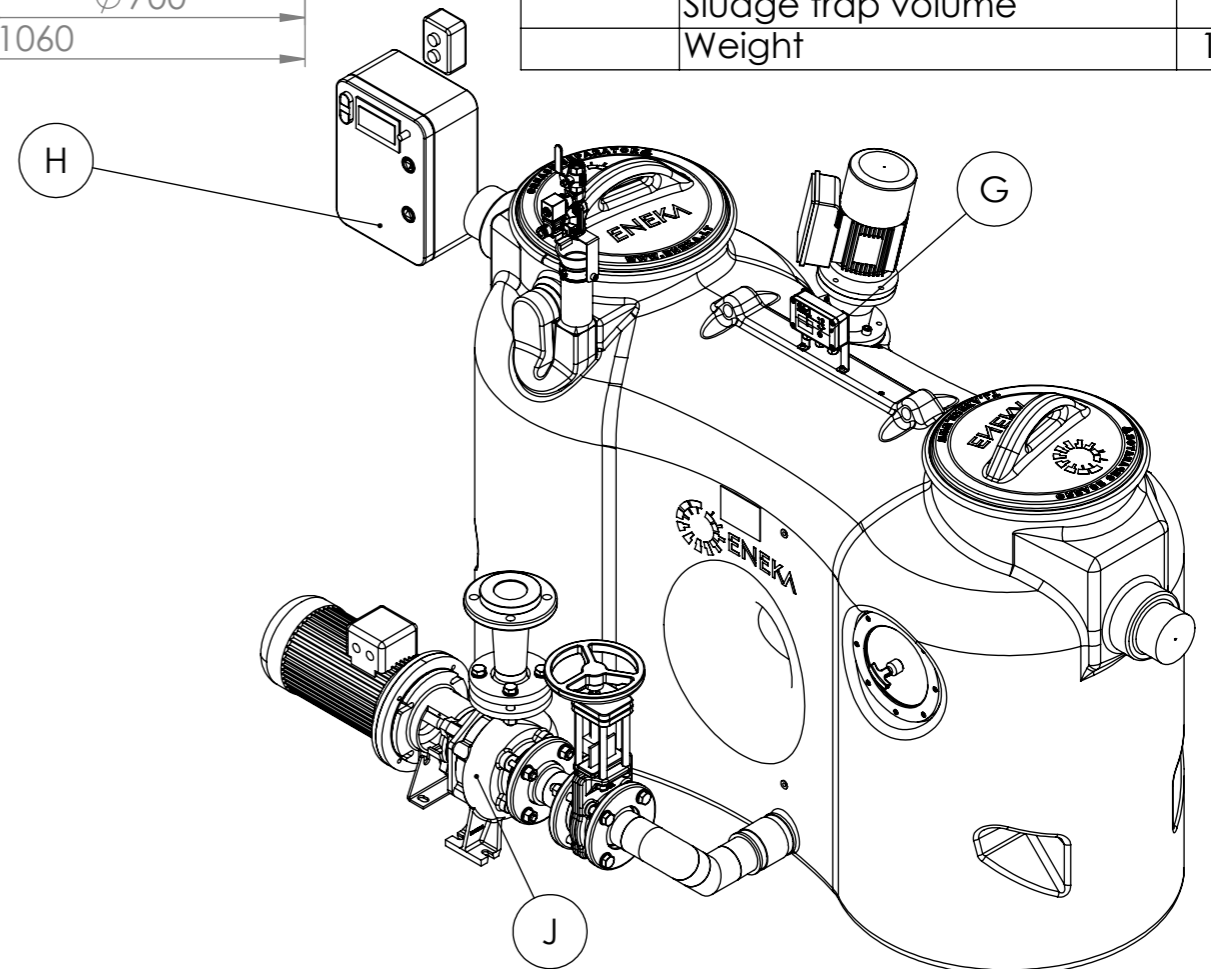
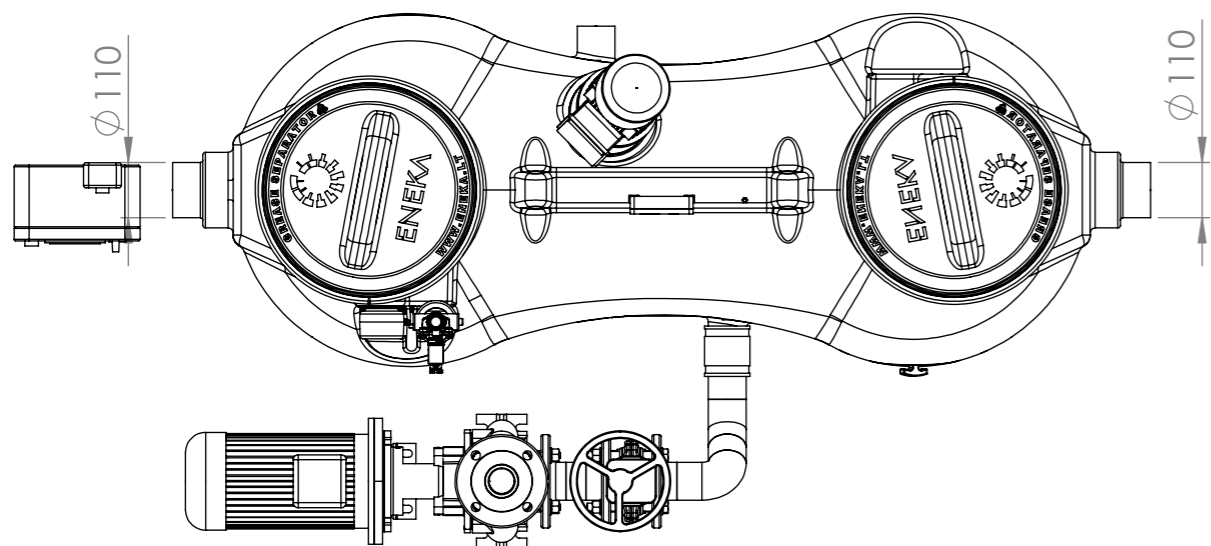

Product <b>Greasly</b>	Name <b>Greasly 2A Pump</b>	Scale <b>1:15</b>
Design by <b>V.Laucius</b>	Checked by <b>E.Mozuraitis</b>	Approved by <b>E.Kuodis</b>
<b>UAB ENEKA</b> Vandziogalos g. 94 LT-47467 Kaunas, Lithuania tel. +37037377441, faks. +37037377907 www.eneka.lt, info@eneka.lt		Drawing type <b>Customer drawing</b>  Drawing no. -  Date <b>6/10/2021</b>
Construction site -		Lang. <b>en</b> Sheet <b>1</b>